

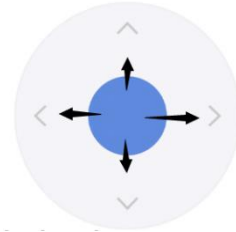

## Part 2 【APP Quick button function introduction】

### 1,Set and Call preset:

Click the "PTZ" on the APP interface, Go the preset position setting keyboard, please select "advanced preset position" and the APP will pop up Numeric keypad button. You can use this numeric keypad to set presets, call presets and turn on some special features. If we need to set the 1th preset, we need to Click 1 on the keyboard, then click the "Settings" button to set 1th preset successfully; if you want to call 1th preset, click 1 on the keyboard, Then click "Call", Call 1th preset successfully



### 6,How control PTZ

Click  Image pan/tilt direction button in the video box. Please follow these direction buttons to operate the direction of rotation of the gimbal

## Part 4 【Function Operation and Description】

### Professional name explanation;

**Set:** set preset,      **Call:** Call preset

[N]+[set]=Enter N first and then click SET.

"+"=Then

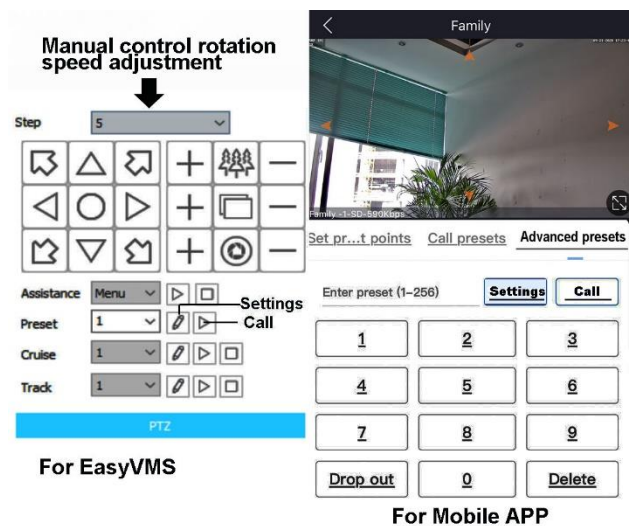

### 1. Communication settings : Default PELCO-D/115200)

### 2. Control the speed dome up ,down and left right rotation

Users can control the speed dome up and down movement by NVR & client soft-ware & mobile app (P2P) & keyboard Joystick's movement can control the speed dome's action. when the joystick turn right, the speed dome also turn right. So the speed dome's movement agree with joystick's movement.

### 3. Preset settings

Rotate the camera to the position you want, then set this position to "N" preset

[N] +[SET] ,N is preset point, 1-255 number can be optional (But the command Preset isn't include). Set= set preset

### 4. Call preset( need set the corresponding preset point) : [N]+[CALL]

N for preset point, 1-255 number can be optional, camera can move to preset point after call, Zoom, focus and aperture lens will automatically change to preset parameters, camera preset display on the monitor.

### 5,Set auto tracking

1) First set a return position: the position of the camera return after the end of the tracking (Home preset position)

Control the camera, rotate the camera to the position you want, and set the 88<sup>th</sup> preset

Setting method: [88]+[Set]

### 2) Open/Close tracking (Default Close)

Call 98 for turn on Humanoid tracking, Setting method: [98]+[Call];

Call 99 for Trun on cruise tracking, Setting method: [98]+[Call];( only Suitable for humanoid tracking)

Call 100 for Turn on cruiss tracking, Setting modethord: [100]+[Call];( only Suitable for Motion detection tracking)

set 96 for turn off tracking, Setting method: [96]+[Set]

### Principle explanation of cruise tracking function:

Before turning on tracking, you need to set the camera's cruise point in advance. A maximum of 16 preset points can be set. These cruise points are the few locations you want to monitor. The camera will cruise back and forth between these locations to find a tracking target. Really made a camera monitors multiple angles of demand. Turn on cruise trackingfunction,The camera will cycle moving through the preset cruise points. When the person is detected, the camera will turn on the tracking. After the tracking is completed, the camera automatically resumes the cruise until the next time the person is detected, the tracking is turned on again

#### **8,Delete all preset point**

[93] +[Set] ,Set no.93 preset, Clear the all preset;Setting method :[93]+[Set] .

#### **9,Auto scan(Horizontal rotation)**

[120]+[CALL], call No.120 ,the lever of 360 degree clockwise automatic scanning

##### **Modify speed of Auto scan :**

[120]+[Set] +[N]+[Set]; (N=1-100; N represents scan speed percentage,default is 10=10 degee/sec)

If you wanto to change speed of auto scan to **50** degee/sec;

Setting method: [120]+[Set] +**[50]**+ [Set]

#### **10, Cruise settings**

Before you start cruising, you first need to set some preset position in the cruise path.,**Please refer to “ 3.Preset settings”**

[115]+[CALL] for Open the first Cruise of 1-16 to scan ;

[116]+[CALL] for Open second Cruise of 17-32 to scan

[117]+[CALL] for Open the third Cruise of 33-48 to scan

##### **Modify the stay time of the Cruise:**

[116] +[Set] + [N]+[Set]; (N=1-255; N represents the dwell time at each preset,default is 5 seconds)

If you change the dwell time to **10 seconds**.Setting method:[116]+[Set] + **[10]**+ [Set]

##### **Modify speed of the Cruise:**

[115] +[Set] + [N]+[Set]; (N=1-100; N represents the dwell time at each preset,default is 10=10 degee/sec)

If you wanto to change speed of **Cruise** to **50** degee/sec;Setting method: [120]+[Set] +**[50]**+ [Set]

Part 4 【Common functions operating Express】				
Function name	Explanation	Preset	Call	Set
Set return position for tracking	The camera will return the position when camera tracking end	88		√
Close auto tracking	Close auto tracking	96		√
Open Humanoid tracking	Only track people	98	√	
Open cruise tracking	Open auto tracking for People	99	√	
Open Motion cruise tracking	Open auto tracking for any moving objects	100	√	
Humanoid tracking horizontal speed adjustment	113+set+N+set,N=Percentage of maximum speed,	113		√
Humanoid tracking vertical speed adjustment	114+set+N+set,N=Percentage of maximum speed,	114		√
Motion Detection tracking horizontal speed adjustment	117+set+N+set,N=Percentage of maximum speed,	117		√
Motion Detection tracking horizontal speed adjustment	118+set+N+set,N=Percentage of maximum speed,	118		√
Dipped beam and high beam switch	The user can arbitrarily set the near light and the remote light to switch position.	101	√	
Set tracking hold time	105+call+X+set, X=2-100 seconds	105	√	
Set tracking zoom value	102+set+X+set,X=1-50, X= 10 steps			
Full IR open	The user can arbitrarily set the position where the near light and the far light are simultaneously turned on.	102	√	
IR light auto mode	Infrared light is controlled by changes in light brightness	149		√
IR light Forced on mode	IR light is always on, and the camera stays in night mode.	150		√
IR light Forced to close	IR light is always off during , and the camera is in day mode	149	√	
Auto scan(pan)1	360 degree clockwise rotation scan	120	√	
Auto scan(pan)2	360 degree counterclockwise rotation scan	121		
Auto scan(pan)3	360-degree round-trip scanning	122		
Modify speed of Auto scan	[120]+[Set] +[N]+[Set]; (N=1-100; N represents scan speed percentage,default is 10=10 degee/sec)	120		√
Open the first cruise	Open the first cruise without Tracking	115	√	
Open the second cruise	Open the second cruise without Tracking	116	√	
Open the third cruise	Open the third cruise without Tracking	117	√	
Set cruise speed	[115] +[Set] + [N]+[Set]; (N=1-100; N represents the dwell time at each preset,default is 10=10 degee/sec)	115		√
Modify the stay time of the Cruise	[116] +[Set] + [N]+[Set]; (N=1-255; N represents the dwell time at each preset,default is 5 seconds)	116		√
Left limit	Set Left limit	110		√
Right limit	Set Right limit	111		√
Save left-right position	Save left-right position	112		√
Turn on left - right scan	Turn on left - right scan	112	√	
Modify the speed limit scan	Modify the speed of right and left limit scan:110+call+N+call, (N=1-100; N represents Cruising speed percentage,default is 10 degee/sec)	110	√	
Set the Home position	[125]+[Call]+[N]+[Call] ,N=Preset ,default N=1,1th preset position	125	√	
Open Home position	[124]+[Call]	124	√	

Close the Home position	[124]+[set]	124		√
Set the Home start time	125+set+N+set N (N=1-250 ; N represents start time,default N=5= 5 seconds )	125		√
Open Lens focal length and speed match	PTZ speed, lens zoom automatic matching is enabled (default is on)	108	√	
Open ZOOM/Speed automatic matching( default)	ZOOM and rotation speed are automatically matched, the larger the ZOOM, the slower the rotation speed	108		√
Close ZOOM/Speed automatic matching( default)	ZOOM has nothing to do with rotation speed	108	√	
Delete all preset point	Delete all preset point	93		√
pan/tilt correction	Horizontal and vertical self-test	94	√	
Restore factory settings	64+call+62+call+62+call	64	√	